

# DOOR LINERS STEPS

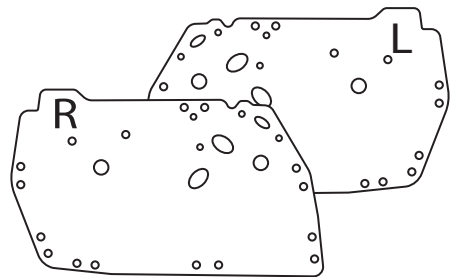

1. Check your set and identify the corresponding side of your liner.

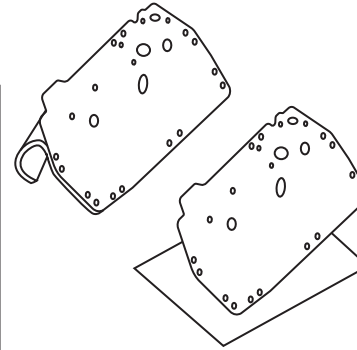

5. Start by partially detaching the up side of the liner from the back paper. Match the perforations and the gaps of the door. Once in place pull down the backing paper completely against door while doing it.

2. Removing dirty, oil or any residue is very important. A clean surface will guarantee the adhesion of the liner to the door panel.

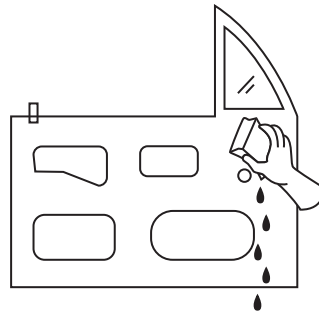

6. Remove moisture (soapy water) with a plastic putty knife.

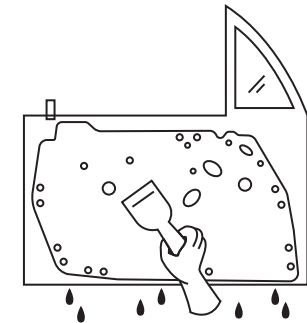

3. Find an extra hand. The liner is a larger decal, and are not to easy to manipulate by only one person.

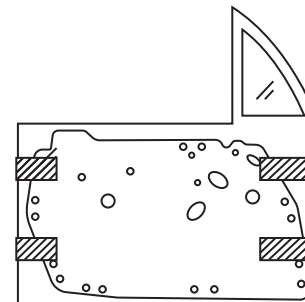

7. With masking tape secure the liner in place until set.

4. It is recommended to damp the door panel with soapy water (better water+shampoo). Makes it easier to set.



8. Let dry, remove the tape and install the door panel.

